



ASE Program – Project Overview and Delivery

January 31, 2019



Project Background

Project Background

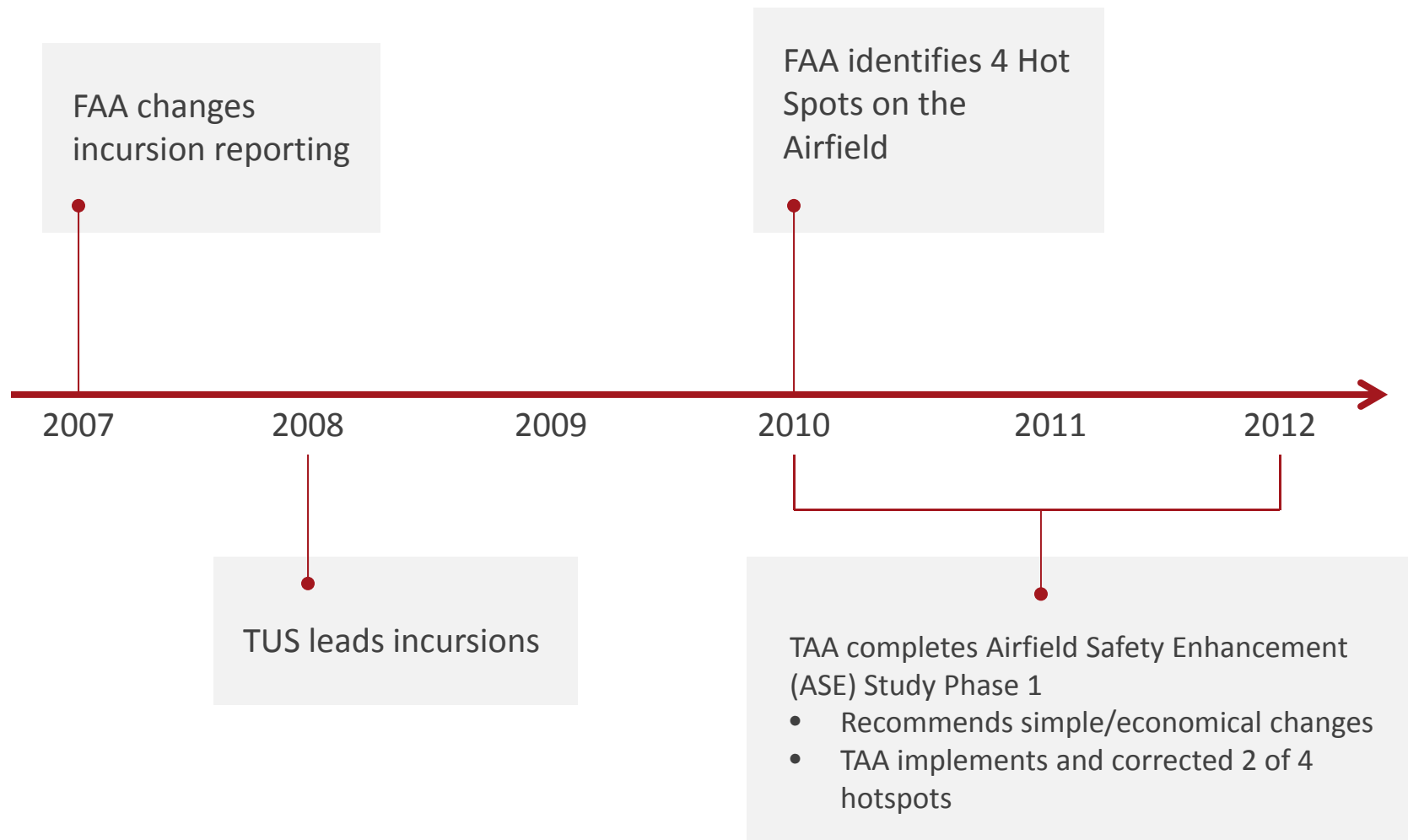

Project Background

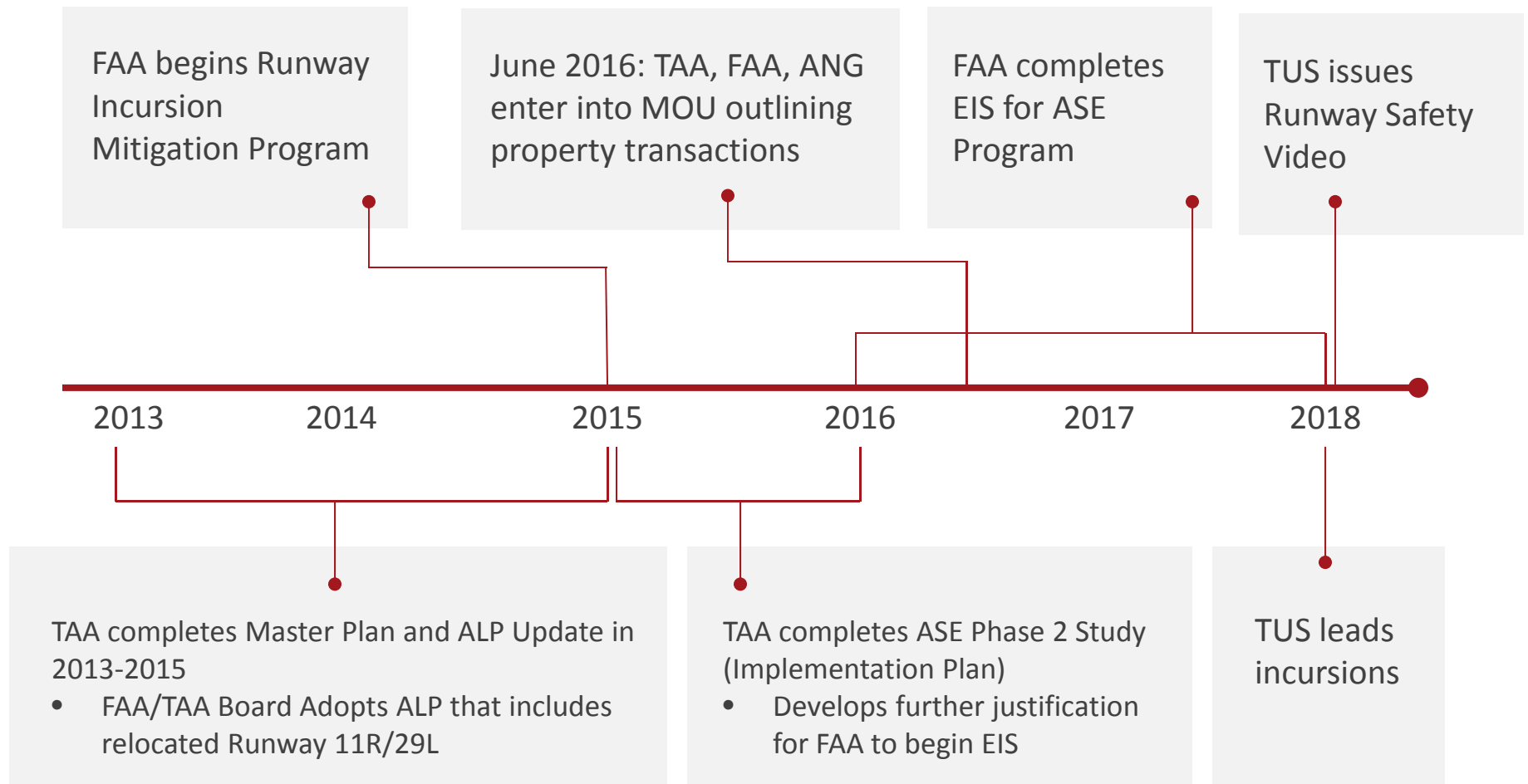



The ASE Project

ASE Project

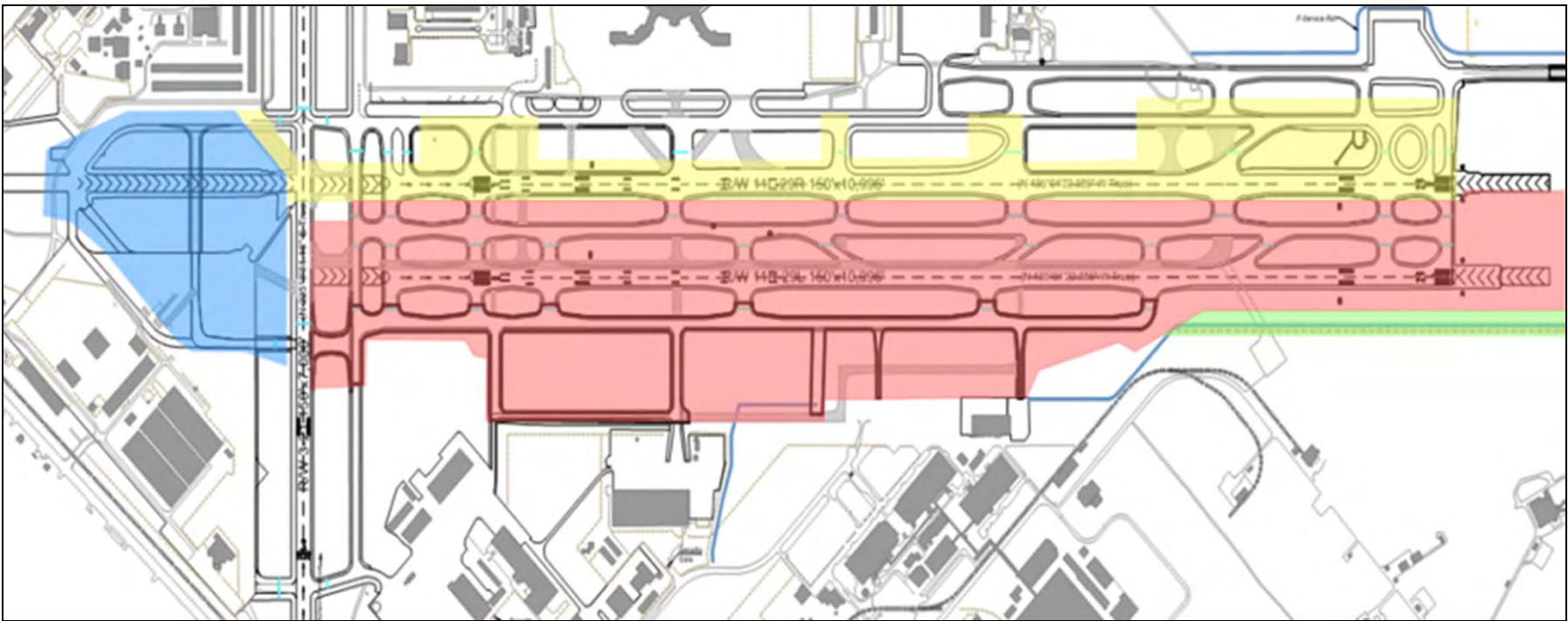

Design & Construction | Goals

- ▶ Expedite project to ensure Airfield Safety Issues are dealt with promptly
- ▶ Maximize flexibility to construct based on funding availability.
- ▶ Maximize participation from contractors & consultants



Project Delivery & Schedule

Overall Project | Project Delivery

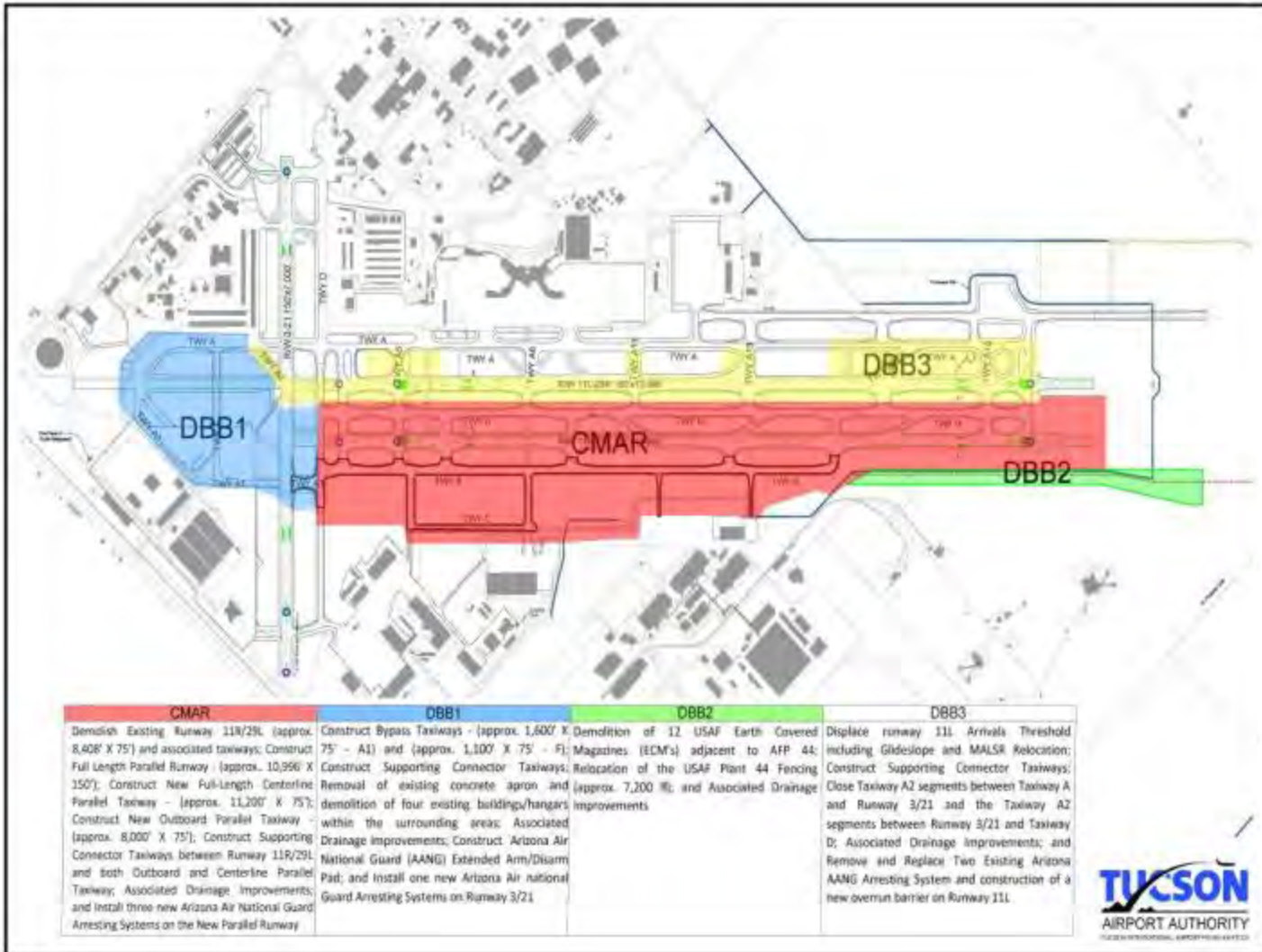

- ▶ 4 Construction Packages
 - 1 CMAR
 - 3 Design Bid Build
- ▶ 4 Design Firm Selections
- ▶ PM/CM (Program Manager/Construction Manager) overseeing entire project



CMAR | Project Delivery

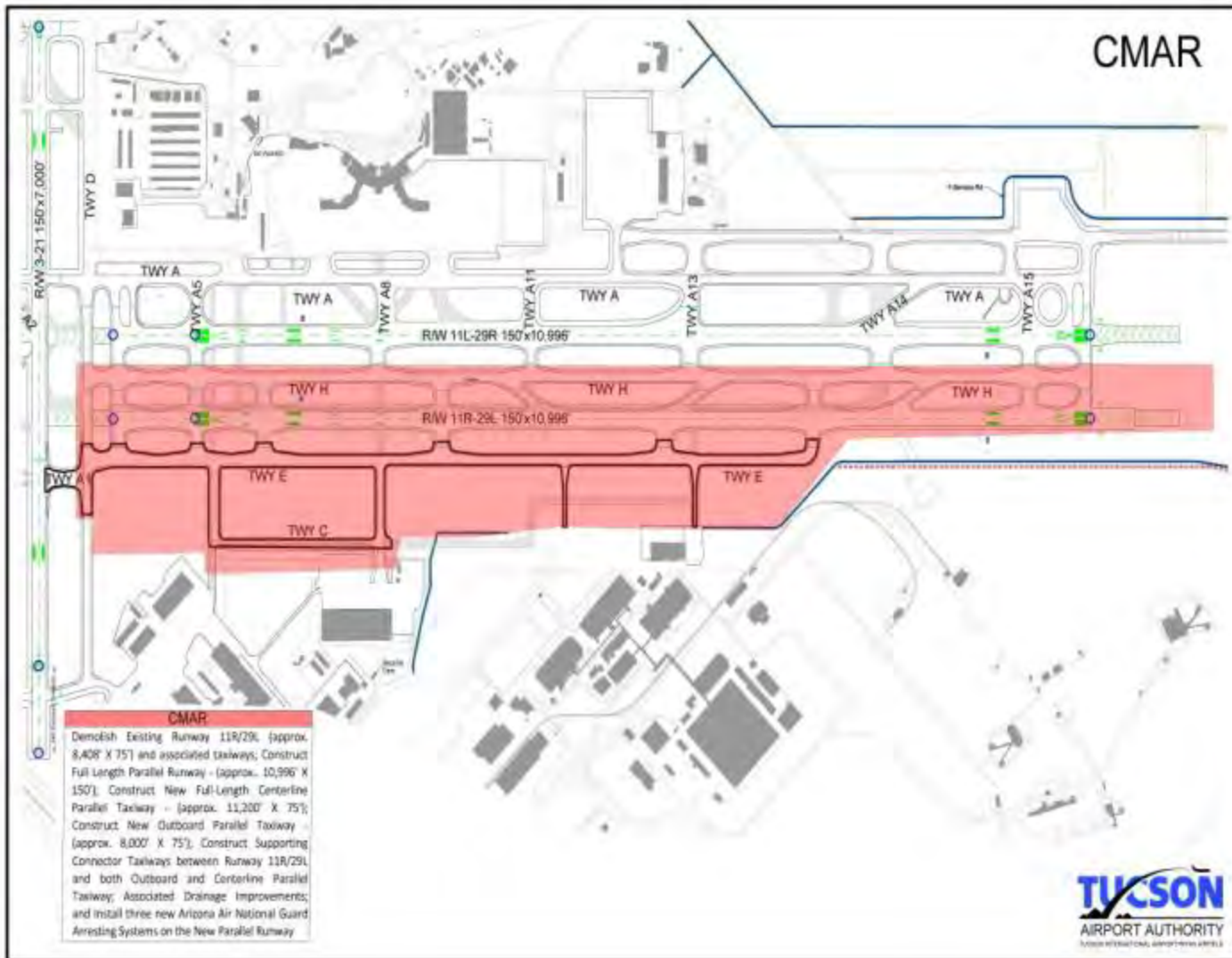

- ▶ Construct Full Length Parallel Runway
- ▶ Demolish Existing Runway 11R/29L
- ▶ Construct New Centerline Parallel Taxiway
- ▶ Construct New Outboard Parallel Taxiway
- ▶ Construct Supporting Connector Taxiways
- ▶ Associated Drainage Improvements

Design Bid Build 1 | Project Delivery

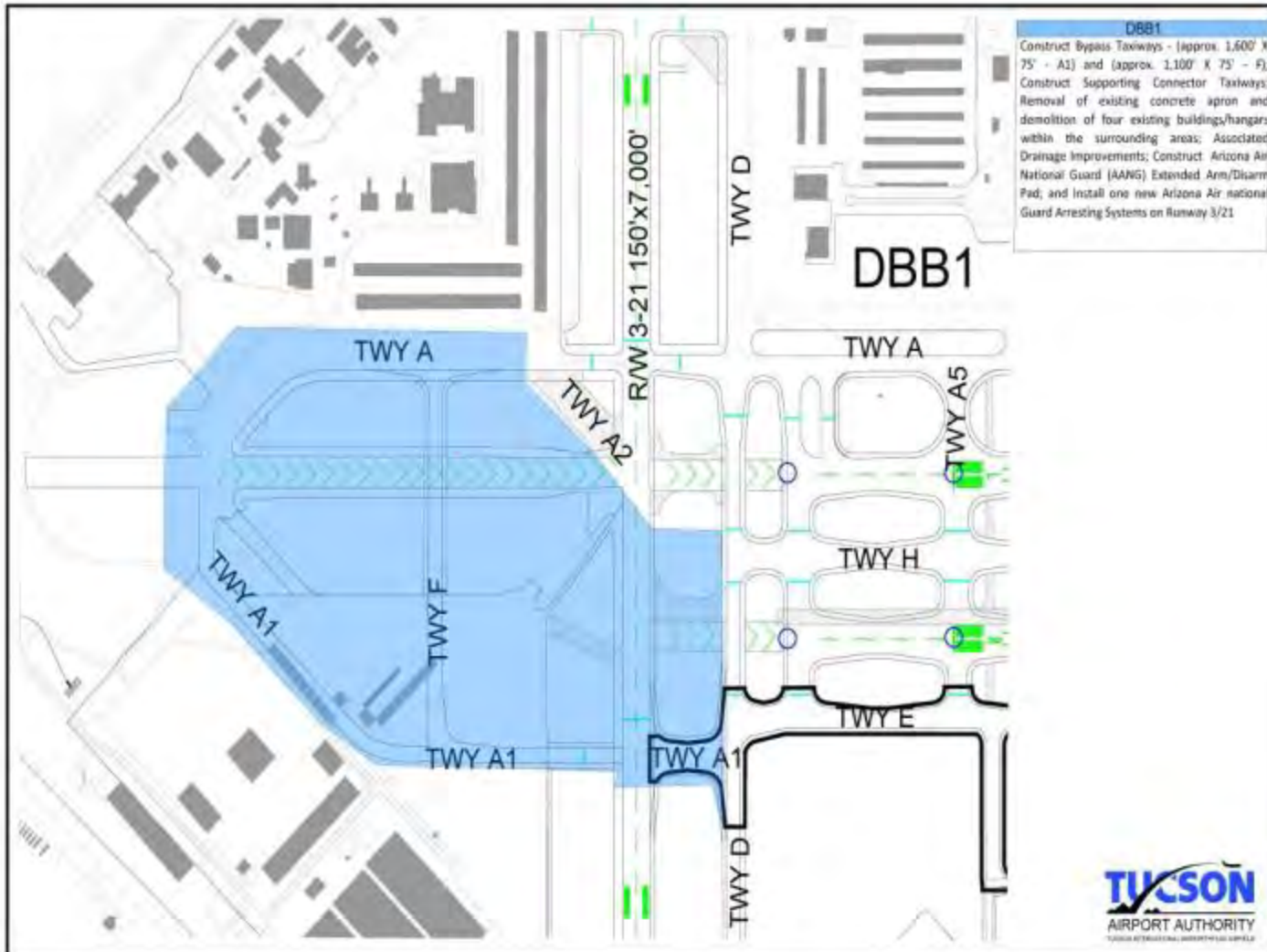

- ▶ Construct Bypass Taxiway
- ▶ Construct / Maintain Arizona Air National Guard (AANG) Extended Arm / Disarm Pad
- ▶ Construct Taxiway F

Design Bid Build 2 | Project Delivery

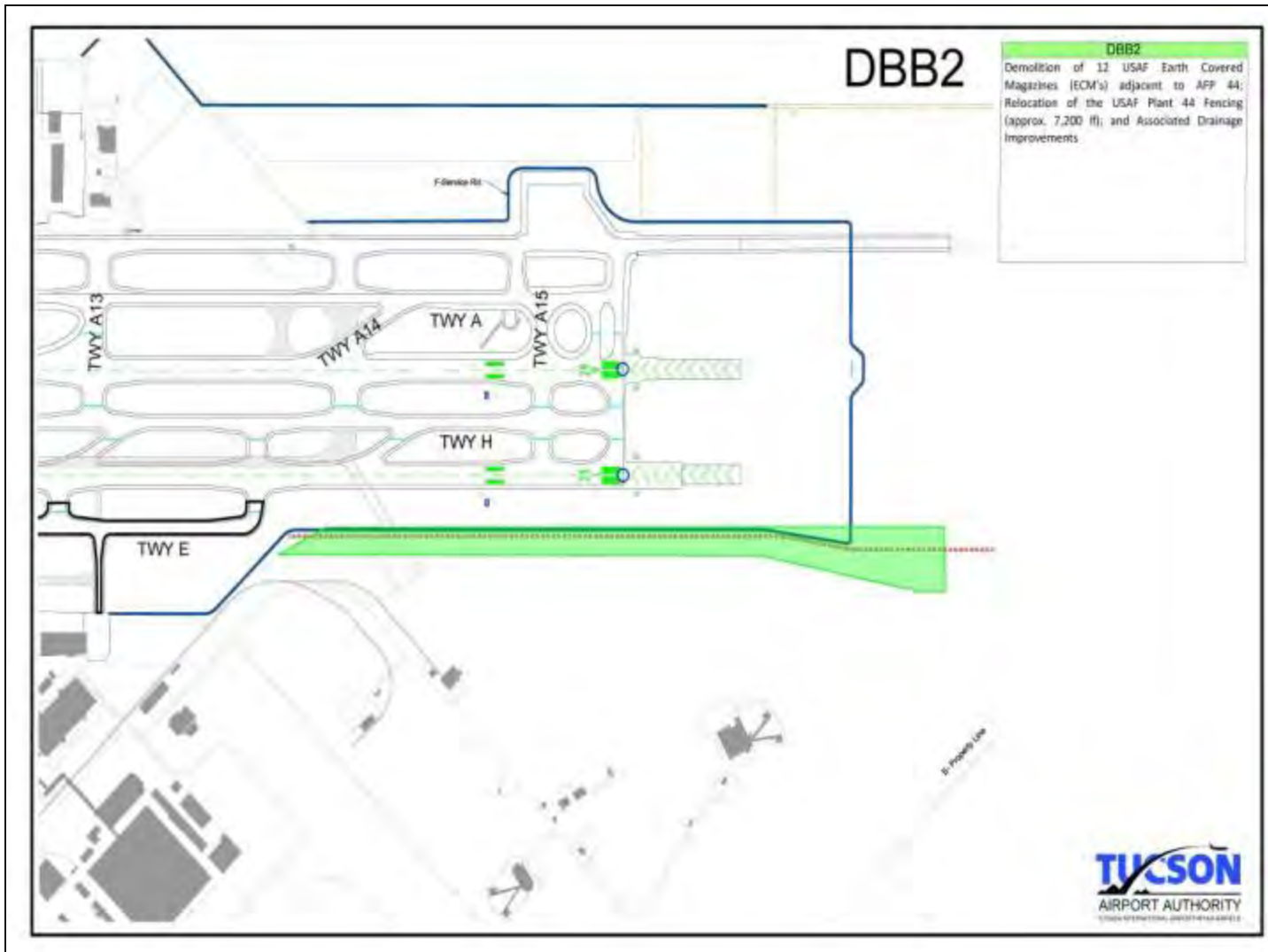

- ▶ Demolition of 12 USAF Earth Covered Magazines (ECMs)
- ▶ Construction of USAF Fence and AOA Fence (approx. 7200 LF)
- ▶ Associated Drainage Improvements

Design Bid Build 3 | Project Delivery

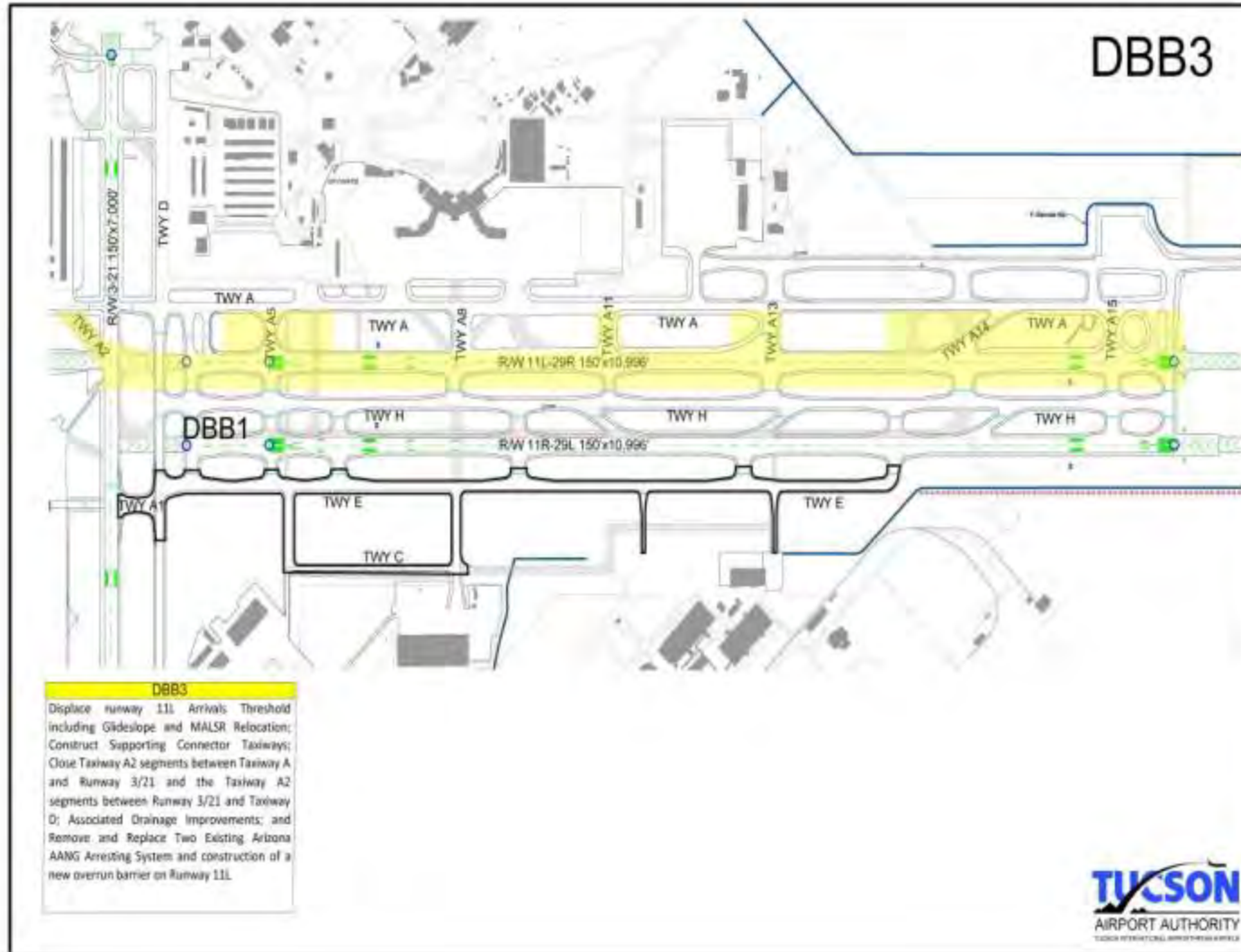

- ▶ Displace Runway 11L Arrivals Threshold
- ▶ Close Taxiway A2 segments between Taxiway A and Runway 3/21 and Between RWY 3/21 and Taxiway D.
- ▶ Construct Taxiway Connectors between Runway 11L/29 R and New Centerline Parallel Taxiway.
- ▶ Associated Drainage Improvements
- ▶ Relocation of Glideslope & MALSR

PM/CM Duties

- ▶ Overall Program Coordination
- ▶ Extension of TAA Project Management Staff
- ▶ Project Controls
- ▶ FAA Flight Procedure & NAVAID Coordination
- ▶ General Construction Administration for all 4 packages
- ▶ Full Time Construction Observation
- ▶ FAA required Material Acceptance Testing (subconsultant)
- ▶ AGIS as built surveys

PM/CM Team, including sub-consultants, can not be on any of the design teams or construction teams

Design Professional Duties

- ▶ Preliminary Design
 - Field Surveys
 - Geotechnical Investigation
- ▶ Detailed Design & Construction Drawings
 - Engineer's Report (including detailed cost estimates)
 - Plan Drawings
 - CSPP Development
- ▶ Construction Duties
 - Shop Drawing/Submittal Review
 - RFI and Change Order Review (as needed)
 - Site Visit and construction meeting participation (as requested)

CMAR Duties

- ▶ **Pre-construction Services**
 - Constructability Reviews
 - Construction Phasing Assistance
 - Materials Selection Assistance
 - Value Engineering
 - Subsurface / Utility Investigations
 - Cost Estimating

ASE Team Selection Expectations

- ▶ PM/CM will be an Extension TAA staff.
Working side by side.
- ▶ Selection Focus will key on team
concept
- ▶ CMAR Designer and Contractor
collaboration

Ancillary Project Parameters

▶ Noise Mitigation

- Offer to sound insulate the following:
 - 27 single-family housing units
 - Four two-family housing units
 - 17 multi-family housing units
- Offer to acquire and relocate the following:
 - 19 manufactured / mobile housing units

Project Schedule

- ▶ Dependent upon FAA funding flow/availability
- ▶ Anticipate 4–6 years for design & construction

Project Schedule

- ▶ PM/CM RFQ Advertisement ~ Mid-February
- ▶ Design Professional RFQ Advertisement
(CMAR, DBB1, DBB2, DBB3) ~ Mid-March
- ▶ CMAR Contractor Advertisement ~ Early Summer
- ▶ SRM Facilitator Selection ~ Summer
- ▶ Design Kickoff ~ Late Summer / Early Fall

Consultant Selection

- ▶ Three Requests for Qualifications will be issued:
 - On-Site PM/CM Services for 10119102 ASE Program. Tentatively advertise mid-February, 2019.
 - Design Professional Services for 3 Design-Bid-Build Projects and 1 Construction Manager at Risk (CMAR) Project. Tentatively advertise mid-March, 2019
 - Firms must designate which project(s) they wish to be considered for on a form to be attached to the RFQ. This form must be submitted with Statement of Qualifications.
 - CMAR Construction Services. Tentatively advertise mid-June, 2019

Consultant Selection

- ▶ Selection processes conducted pursuant to FAA, ADOT, CFR procurement guidelines:
 - Advertise for 30 days.
 - Pre-Submittal meeting.
 - Shortlist firms.
 - Interview short-listed firms.
 - Final selection.

DBE and SBE Requirements

Governing Regulation – 49 CFR Part 26

- ▶ Condition for Receiving Federal Assistance – Airport Improvement Program (AIP)
- ▶ Subject to Title 49 CFR Part 26 – Participation of Disadvantaged Business Enterprises in Department of Transportation Financial Assistance Programs

DBE and SBE Requirements

- ▶ Goal: Achieve Maximum Participation Possible of DBE/SBE Firms through Race/Gender Neutral Means
- ▶ Required Outreach Measures and Documentation
- ▶ Overall Aspirational DBE Goal of 7%
- ▶ DBE Firms Must Be Certified Prior to Submittal of Proposal/Bid To Be Counted Toward Aspirational Goal

DBE and SBE Requirements

Arizona Unified Certification Program (AZUCP)

- ▶ TAA – Part of the Arizona Unified Certification Program (AZUCP)
- ▶ Utilize DBE Directories
- ▶ Honors Certifications and Re-Certifications
- ▶ The Partners of AZUCP are:
 - Arizona Department of Transportation,
 - The City of Phoenix
 - The City of Tucson
- ▶ Online Applications – Arizona Unified Transportation Registration and Certification System (AZ UTRACS) at <https://utracs.azdot.gov/>

The background features a repeating pattern of 3D question marks in a light blue-grey color, set against a slightly darker background. The question marks have a subtle shadow, giving them a three-dimensional appearance. In the center, there is a white rectangular box with a thin dark red border. Inside this box, the word "Questions?" is written in a bold, dark red, sans-serif font. At the bottom of the slide, there is a solid dark red horizontal bar.

Questions?