

**NOTICE TO ALL PROPOSERS**

**ADDENDUM NO. 2**

**TO THE REQUEST FOR PROPOSALS FOR  
TUCSON AIRPORT AUTHORITY PROJECT**

**10122470 REPLACE PARKING AND REVENUE CONTROL SYSTEM (PARCS)**

**January 25, 2023**

The following Addendum dated January 25, 2023, shall be made a part of the Request for Proposal (RFP) dated December 21, 2022, for 10122470 Replace Parking and Revenue Control System (PARCS).

**GENERAL**

1. Drawings of the Hourly/Daily, Economy, and Garage parking spaces are attached to Addendum #2.

**CHANGES TO DOCUMENTS**

None

**RESPONSES TO QUESTIONS**

1. Please provide a list of certified Disadvantaged Business Enterprises (DBEs).

Answer: We refer firms to the Arizona Department of Transportation's certified DBE database (AZ UTRACS). The following link will allow you to do a customized search for certified DBEs who may have the experience you are looking for on this project. <https://utracs.azdot.gov/Search?quickSearch=DBE>

Additional TAA DBE information, including our DBE Part 26 Program for 2021-2023 can be found via the link <https://www.flytucson.com/taa/business/dbe-vendor-registration/>

2. Page 3 of Addendum #1 states that there is an aspirational 7% DBE participation goal. Is this a requirement for the firm if only responding to the CBRS portion (Part 6: CBRS Wireless Network) of the RFP?

Answer: The aspirational goal of 7% applies to any portion of the project the vendor is proposing on. If this goal is not met, then good faith efforts may be requested.

3. Section 5.4 of the RFP stated that the Airport is wanting the PGS installed to the solar panels on the surface lot. Addendum 1 is stated only PGS is required on Level 2 of the garage. Can you verify of the Airport will require a cost proposal for PGS on the surface lot mounted to the solar panels?

Answer: The Parking Guidance System is needed for both the Main Lot (Daily/Hourly) and the 2<sup>nd</sup> level of the Parking Garage.

4. The maps are helpful they unfortunately do not provide the information needed in order to properly spec out the parking guidance system. If TAA does not provide as-built drawings it will be difficult for vendors to provide an exact cost. With that said, is TAA willing to evaluate proposals that include estimated pricing for the parking guidance system?

Answer: Drawings of the Hourly/Daily, Economy, and Garage parking spaces are attached. Estimated pricing for the parking guidance system is acceptable.

# MAIN LOT (HOURLY & DAILY)

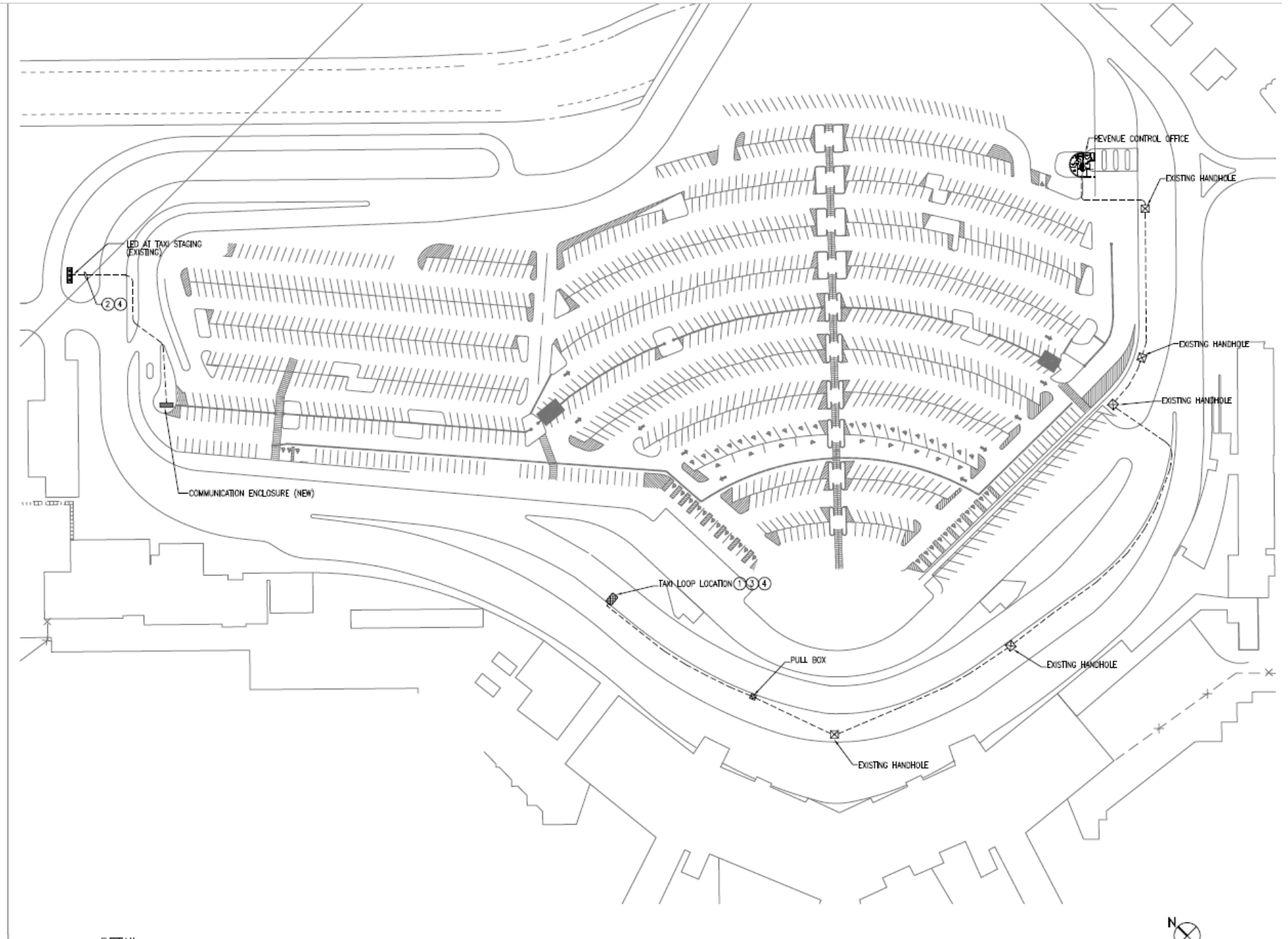

For general reference purposes. Not to scale.

# ECONOMY LOTS (COVERED & UNCOVERED)

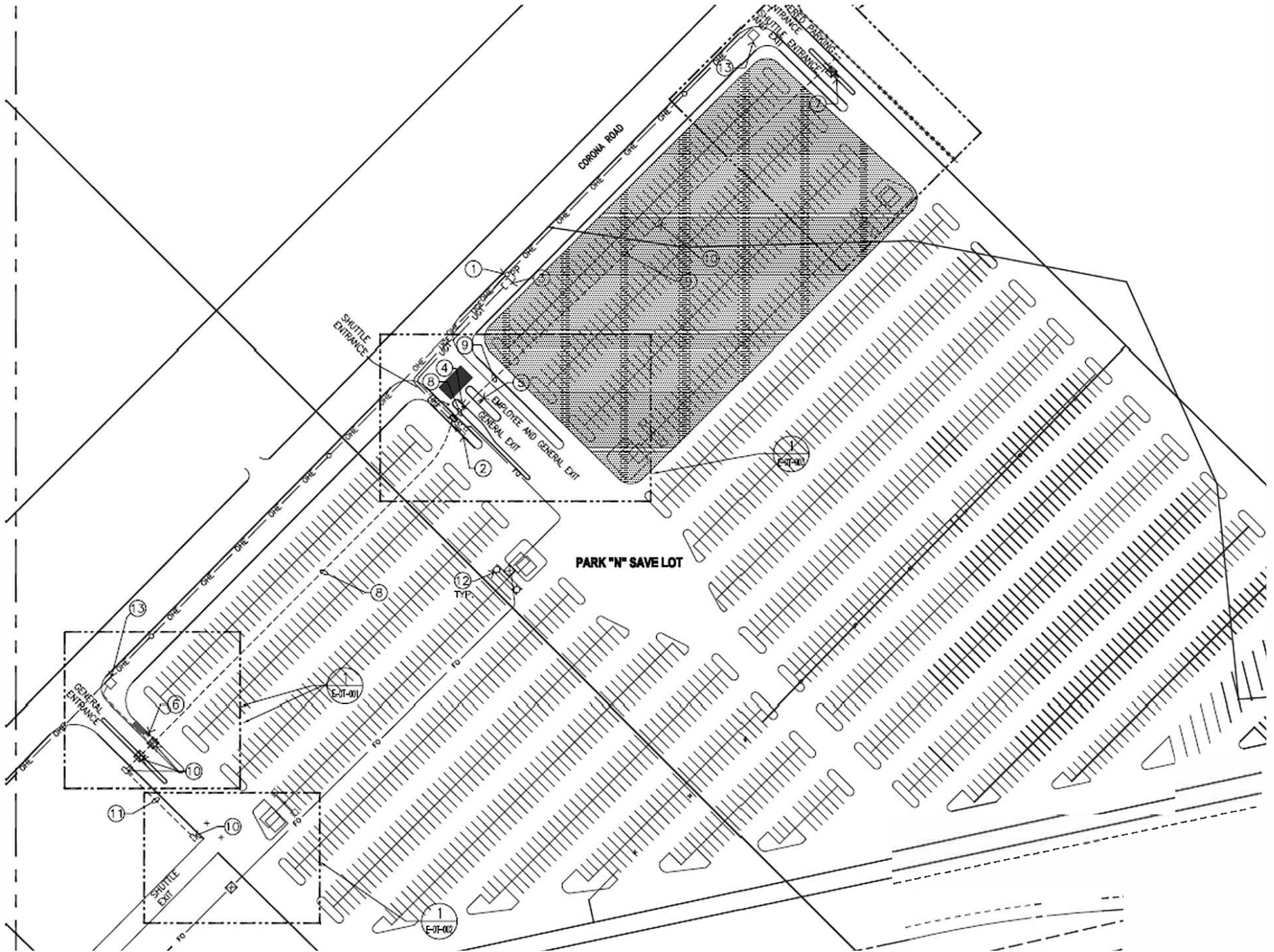

For general reference purposes. Not to scale.

# GARAGE PARKING (2ND LEVEL)

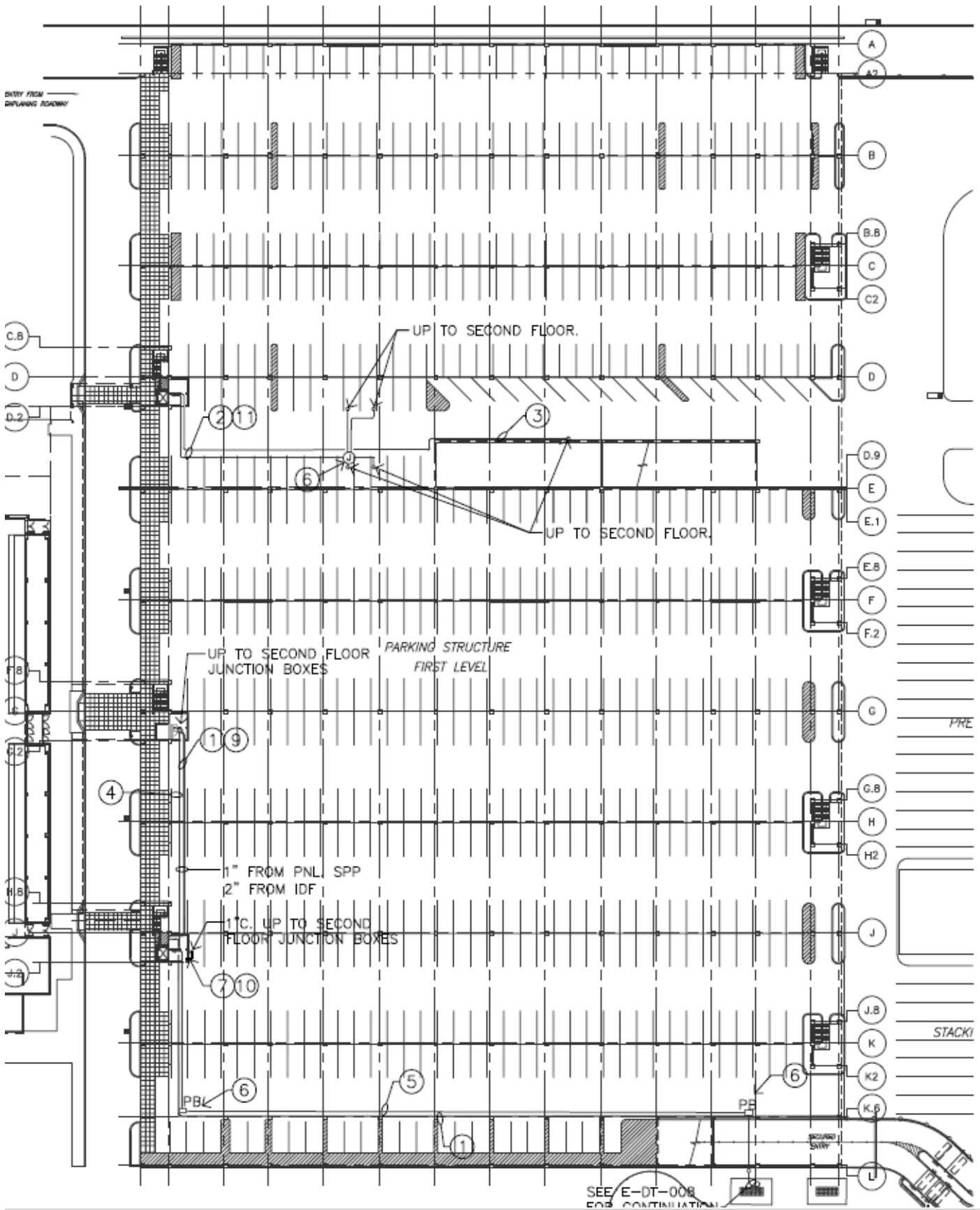

For general reference purposes. Not to scale.